

WASHING MACHINE

Front Loading

USER MANUAL

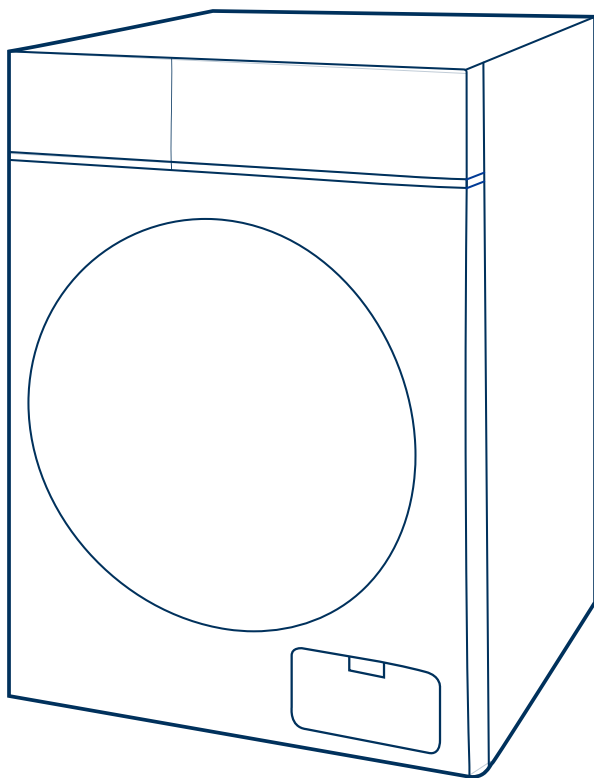

Model:
MFE60-U1002/C31-EU(ND)

Congratulations to your new machine !

This user manual will help you discover all the benefits of your machine and use it the way you want.



We strongly recommend that you read this manual carefully before using the washing machine for the first time. It contains important safety instructions and information relating to the installation, operation and maintenance. Proper handling contributes to efficient, environmentally friendly and safe use and minimises energy consumption during operation. Please always keep the proof of purchase to preserve any warranty claims.

These instructions for use are in general terms. This means: Certain functions apply to your machine, while others do not. We are continuously working on the further development and improvement of our unit types and models. Therefore, we reserve the right to make changes to the design, features and accessories of all types and models without prior notice.

On our website www.midea.com you can also download the user manual in digital form and discover other products. We hope you enjoy using your machine.

Explanation of symbols



Danger

This symbol indicates that there are dangers to the life and health of persons due to extremely flammable gas.



Warning of electrical voltage

This symbol indicates that there is a danger to life and health of persons due to voltage.



Warning

The signal word indicates a hazard with a medium level of risk which, if not avoided, may result in death or serious injury.



Caution

The signal word indicates a hazard with a low degree of risk which, if not avoided, may result in minor or moderate injury.



Notice

The signal word indicates important information (e.g. damage to property), but not danger.



Observe instructions

Notes with this symbol indicate that you should read the operating instructions carefully.



Observe instructions

This symbol indicates that a service technician should only operate and maintain this appliance in accordance with the operating instructions.

CONTENTS

1 SAFETY INSTRUCTIONS	3	4 MAINTENANCE	28
1.1 Safety Instructions	3	4.1 Cleaning and Care	28
		Cleaning the Cabinet.....	28
2 INSTALLATION	11	Cleaning the Drum	28
2.1 Product Description	11	Cleaning the Door Seal and Glass..	28
Accessories	11	Cleaning the Inlet Filter	29
2.2 Installation	12	Cleaning the Detergent Dispenser..	30
Installation area	12	Cleaning the Drain Pump Filter.....	31
Unpacking the machine.....	13	4.2 Trouble Shooting.....	32
Remove transport bolts	13	4.3 Customer service.....	33
Levelling the machine.....	14		
Connect the water supply hose	14	5 TECHNICAL SPECIFICATION	34
Drain Hose	14		
Acoustic Sponge	15	6 PRODUCT FICHE	35
3 OPERATION	16		
3.1 Quick Start	16		
3.2 Before Each Washing	18		
3.3 Detergent Dispenser	19		
Detergent Recommendation	20		
3.4 Control Panel	21		
3.5 Programmes.....	22		
3.6 Option.....	26		

1 SAFETY INSTRUCTIONS

INTENDED USE

The product is intended only for home use and for textiles in household amounts suitable for washing. This appliance is for indoor use only and not intended for built in use. Only use according to these instructions. The appliance is not intended for commercial use.

Any other use is considered as improper use. The producer is not responsible for any damage or injuries that may result of it.

- This appliance is intended to be used in household and similar applications such as:
 - Staff kitchen areas in shops, offices and other working environments;
 - Farm houses;
 - By clients in hotels, motels and other residential type environments;
 - Bed and breakfast type environments;
 - Areas for communal use in blocks of flats or in launderettes.

■ 1.1 Safety Instructions

Please read the following safety information thoroughly and follow it strictly to minimize the risk of fire or explosion, electric shock and to prevent property damage, personal injury or loss of life. Failing to follow these instructions shall void any warranty.

Warning!

This combination of symbol and signal word indicates a potentially dangerous situation which may result in death or serious injuries unless it's avoided.

Caution!

This combination of symbol and signal word indicates a potentially dangerous situation which may result in slight or minor injuries or damage to property and the environment.



Note!

This combination of symbol and signal word indicates a potentially dangerous situation which may result in slight or minor injuries.

1 SAFETY INSTRUCTIONS

Warning!

ELECTRIC SHOCK HAZARD

- If the supply cord is damaged, it must be replaced by the manufacturer, its service agent or similarly qualified persons in order to avoid a hazard.

If the machine is damaged, it must not be operated

- unless repaired by the manufacturer, its service agent or similarly qualified persons.

Risk of electric shock!

- The appliance can be used by children aged from 8
- years and above and persons with reduced physical, sensory or mental capabilities or lack of experience and knowledge if they have been given supervision or instruction concerning use of the appliance in a safe way and understand the hazards involved. Children shall not play with the appliance. Cleaning and user maintenance shall not be made by children without supervision.
- Children should be supervised that they do not play with the appliance.
- Children 3 years and under shall be kept away from the appliance or continuously supervised.
- Animals and children may climb into the machine. Check the machine before every operation. Do not climb or sit on the appliance.
-

1 SAFETY INSTRUCTIONS

INSTALLATION LOCATION AND SURROUNDING

- All washing and additional substances are to be kept in a safe place out of the reach of children.

Do not install the machine on a carpet floor. The

- obstruction of the openings by a carpet can damage the machine.

Keep the appliance clear from heating sources and

- direct sunlight to avoid plastic and rubber parts to corrode.

Do not use the appliance in humid environments or

- rooms containing explosive or caustic gas. In case of water leakage or water splashes let the appliance dry in the open air.

- The appliance must not be installed behind a lockable door, a sliding door or a door with a hinge on the opposite side to that of the washing machine .

- Do not operate the machine in rooms with a temperature of below 5°C. This can cause damages to parts of it. If it is unavoidable, make sure to drain the water completely from the appliance after every use (see “Maintenance - Cleaning of drain pump filter”) to avoid damages caused by frost.

Never use flammable sprays or substances in the

- immediate proximity of the appliance.

1 SAFETY INSTRUCTIONS

INSTALLATION

- Remove all packaging material and transport bolts before using the appliance. Otherwise, serious damage may result.
- This appliance is equipped with a single inlet valve and can be connected to the cold water supply only. Mains plug must be accessible after installation.
- Before washing clothes for the first time, the product
- shall be operated once throughout all the procedures without any clothes inside.
Before using the washing machine, the product shall be calibrated.
- Do not put any excessively heavy objects on the appliance, like water containers or heating devices.
The new hose-sets supplied with the appliance are to be used and that old hose-sets should not be reused.
- Max. Inlet water pressure 1 MPa. Min. inlet water pressure 0.05 MPa.
-

ELECTRICAL CONNECTION

- Make sure the supply cable is not trapped by the machine, it can get damaged.
- Connect the product to a grounded outlet protected by a fuse complying with the values in the “ Technical specifications” table. The grounding installation has to be made by a qualified electrician. Ensure that the machine is
installed in accordance with the local

1 SAFETY INSTRUCTIONS

regulations.

- Water and electrical connections must be carried out by a qualified technician in accordance with the manufacturer's instructions and local safety regulations.

Warning!

- Don't use multiple plugs or extension cords.
- The appliance must not have an external switching device such as a timer or connected to a circuit that is regularly switched on and off. Do not pull the plug out of the mains outlet if there is flammable gas around.
- Never pull out power plug with wet hands.
- Always pull at the plug, not at the cable.
- Always unplug the appliance if it is not being used.

WATER CONNECTIONS

- Check the connections of the water inlet tubes, the water tap and the outlet hose for possible problems due to changes of water pressure. If the connections loosen or leak, close the water tap and get it repaired. Do not use the appliance before the pipes and hoses are installed properly by qualified persons.
- Glass door may become very hot during the operation. Keep children and pets far away from the machine while it is operating.
- The water inlet and outlet hoses have to be safely installed and remain undamaged. Otherwise, water leakage can occur.

•

1 SAFETY INSTRUCTIONS

- Do not remove the drain pump filter while there is still water in the appliance. Big quantities of water can leak out, and there is a risk of scalding due to hot water.

OPERATION AND MAINTENANCE

- Never use any flammable, explosive or toxic solvents. Do not use gasoline and alcohol etc. as detergents. Only select detergents that are suitable for machine washing.
- Make sure that all pockets are emptied. Sharp and rigid items such as coins, brooches, nails, screws, stones etc. may cause serious damages to this machine.
- Remove all objects from pockets such as lighters and matches before use the appliance.
Thoroughly rinse items that have been washed by hand.
- Items that have been soiled with substances such as cooking oil, acetone, alcohol, petrol, kerosene, spot removers, turpentine, wax and wax removers should be washed in hot with an extra amount of detergent before being dried in the appliance.
- Items containing foam rubber (latex foam), shower caps, water proof textiles, rubber backed articles and clothes or pillows fitted with foam rubber pads should not be washed in the machine.
- Fabric softeners or similar products should be used are recommended in their instructions.
Never try to open the door forcefully.

1 SAFETY INSTRUCTIONS

- The door will unlock shortly after the end of a cycle. Please do not close the door with excessive force. If
- it is found difficult to close the door, please check if the clothes are properly inserted and distributed. Always unplug the appliance and close the water tap before cleaning and maintenance and after each
- use.
- Never pour water over the appliance for cleaning purpose. Risk of electric shock!
- Repairs shall only be carried out by the manufacturer, its service agent or similarly qualified
- persons in order to avoid a hazard. The producer will not be responsible for damages caused by the intervention of not authorized persons.
-

TRANSPORT

- Before Transport:
 - Bolts shall be reinstalled to the machine by a specialized person;
 - Accumulated water shall be drained out of the machine.
- This appliance is heavy. Transport with care. Never hold any protruding part of the machine when lifting. The machine door can not be used as a handle.

1 SAFETY INSTRUCTIONS

ENVIRONMENT

Disposal of old appliances
(Only for EU countries)

This appliance is labelled in accordance with the European Directive 2012/19/EU on waste electrical and electronic equipment (WEEE). The directive provides the framework for the EU-wide take-back and recycling of waste equipment.



The devices marked with this symbol
must not be disposed of in household waste!

As a manufacturer, we ensure environmentally friendly treatment and recycling of old appliances within the scope of product responsibility. Our products are registered with the authorities for electrical appliances and packaging. For further information on collection and disposal, please contact your local authority, city council or your

(specialised) retailer. Already during the development of new appliances, we pay attention to a high recyclability of the materials used. High recycling rates are achieved via the take-back system to reduce the burden on waste dumps and the environment. Together, we are making an important contribution to environmental protection.

2 INSTALLATION

2.1 Product Description

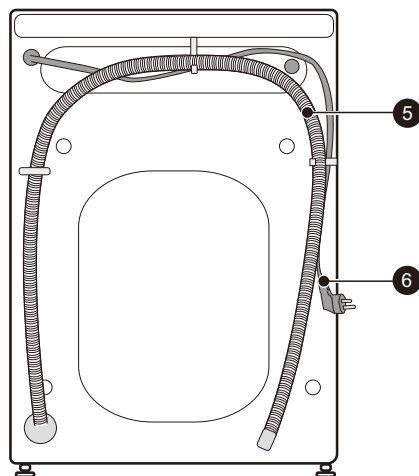
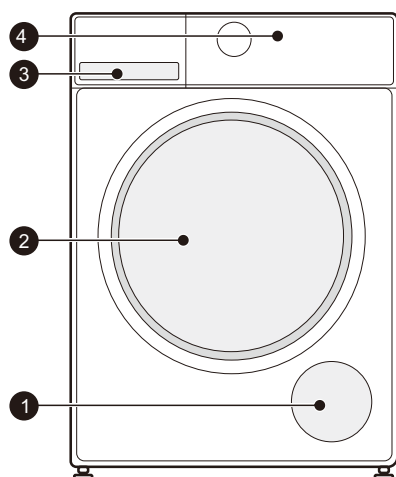

1 Service flap

2 Door

3 Detergent dispenser

4 Control panel

5 Drain hose

6 Power supply cord



Note!

- The product picture is for illustration only, please refer to real product as reference.

Accessories

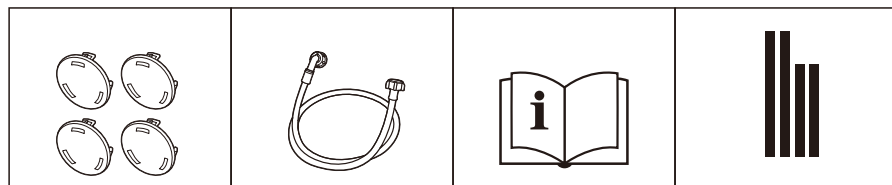

4 x Cover caps

1 x Supply hose cold water

1 x Owner's manual

Acoustic sponge (optional)

2 INSTALLATION

2.2 Installation



Tools Needed If Installation By Yourself (not include)

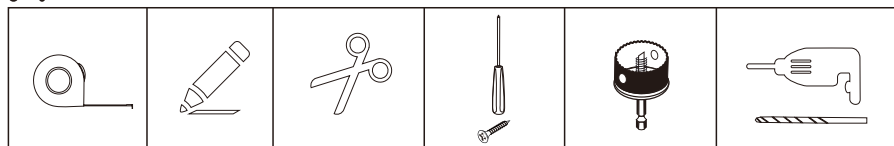

Installation area



Warning!

- Stability is important to prevent the product from wandering!
- Make sure the machine is standing leveled and stable.
- Make sure that the product does not stand onto the power cord.
- Make sure to maintain the minimum distances from the walls as shown in the picture.

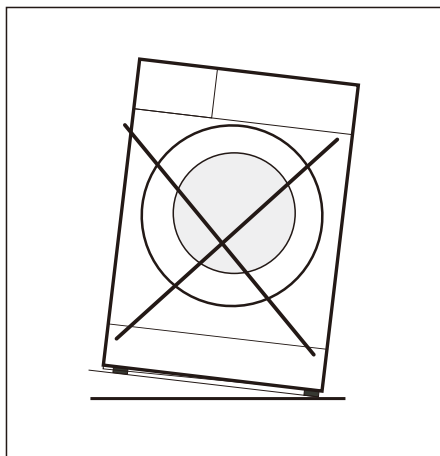
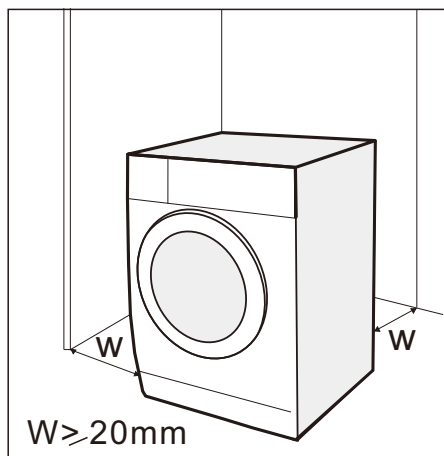

Before installing the machine, the location characterized as follows shall be selected:

1. Rigid, dry, and level surface.
2. Avoid direct sunlight.
3. Sufficient ventilation.
4. Room temperature is above 5°C.
5. Keep far away from the heat sources such as coal or gas burning appliances.

2 INSTALLATION

Unpacking the machine

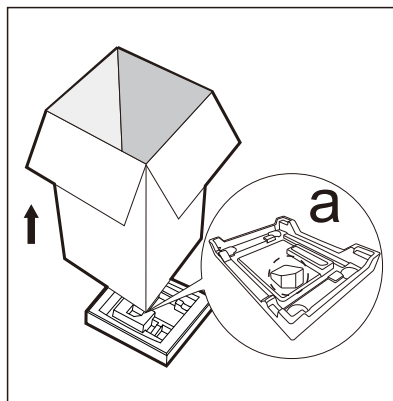

Warning!

- Packaging material (e.g. Films, Styrofoam) can be dangerous for children.
- There is a risk of suffocation ! Keep all packaging well away from children.

1. Remove the cardboard box and styrofoam packing.
2. Lift the washing machine and remove the base packaging. Make sure the small triangle foam (a) is removed with the bottom packaging together.
If not, lay the unit down on the side surface and remove it manually.
3. Remove the tape securing the power supply cord and drain hose.
4. Remove the inlet hose from the drum.

Remove transport bolts

Warning!

- You must remove the transport bolts from the backside before using the product.

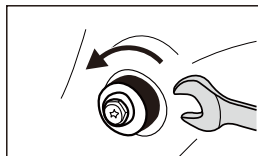

Loosen the 4 transport bolts with a spanner.

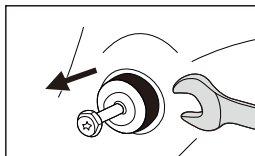

Remove the bolts including the rubber parts and keep them for future use.

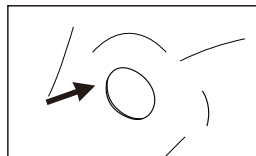

Close the holes using the cover caps.

2 INSTALLATION

Levelling the machine

⚠ Warning!

- The lock nuts on all four feet must be screwed tightly against the housing.

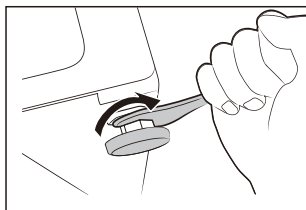

1. Loosen the lock nut.
2. Turn the foot until it reaches the floor.
3. Adjust the legs and lock the nuts with a spanner. Make sure the machine is level using a spirit level.

Connect the water supply hose

⚠ Warning!

To prevent leakage or water damage, follow the instructions in this chapter.

- Do not kink, crush or modify water inlet hose.

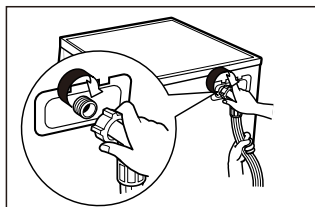

Connect the water supply hose to the water inlet valve and a water tap with cold water as indicated.

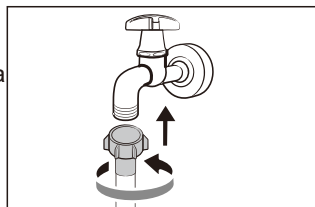

📌 Note!

- Connect manually, do not use tools. Check if the connections are tight.

Drain Hose

⚠ Warning!

- Do not kink or protract the drain hose.
- Position drain hose properly ,otherwise damage might result of water leakage.
- It is not allowed to remove the buckle of drain pipe.

2 INSTALLATION

There are two ways to place the end of drain hose:

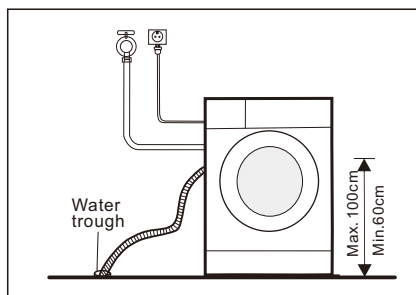

1.Put it into the water trough.

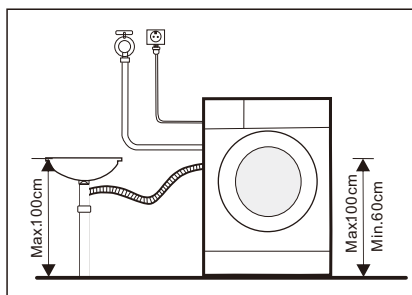

2.Connect it to the branch drain pipe of the trough.

Acoustic Sponge



Note!

- Please make sure to assemble the acoustic sponges, which can effectively reduce the noise caused by the machine while working, in order to provide you with a more peaceful and quiet living environment.

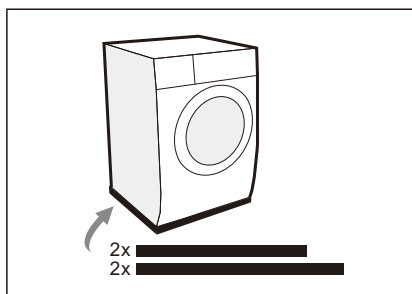
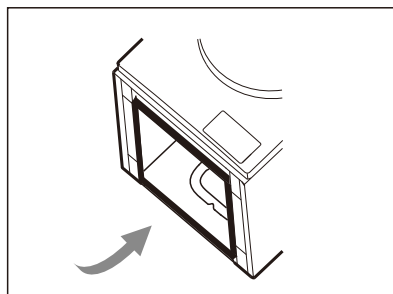

1. Get the machine laid on the floor, using some soft material like foam or clothes between the machine and floor for a protection.
2. Stick the 2x longer sponges to the longer bottom edges of machine, and the 2x shorter sponges to the shorter bottom edges.

3 OPERATION

3.1 Quick Start



Caution!

- Before washing, please make sure the washing machine is installed properly.
- Your appliance was thoroughly checked before it left the factory. To remove any residual water and to neutralize potential odors, it's recommended to clean your appliance before first use. For this reason, start the Cotton program at 90°C without laundry and detergent.

1. Before Washing

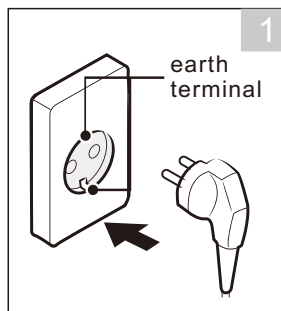

Plug in

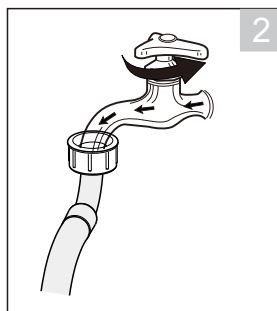

Open tap

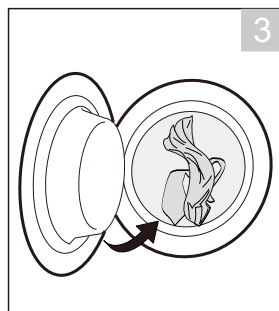

Load

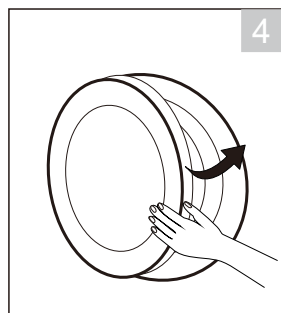

Close door

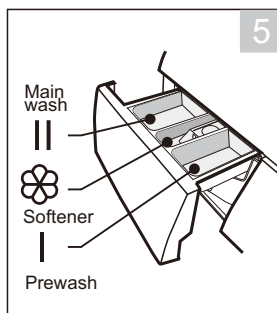

Add detergent



Note!

- Detergent need to be added in compartment I if the pre-wash function is selected.

3 OPERATION

2. Washing

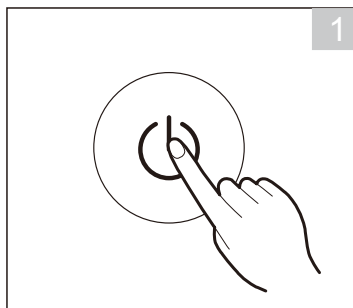

Power on

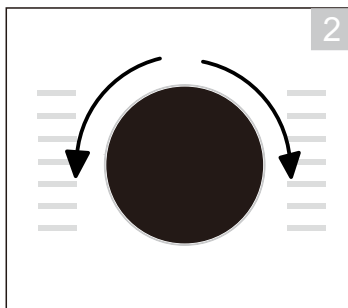

Select programme

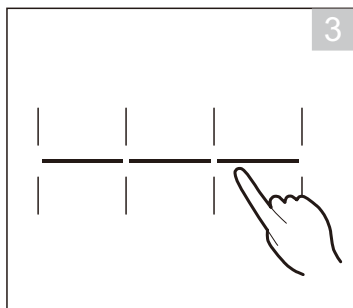

Select function or remain default settings

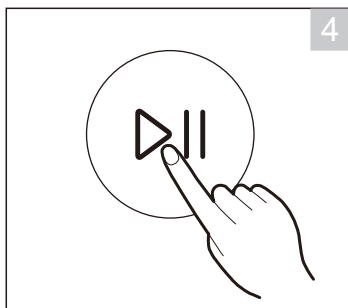

Press Start/Pause to start the program

3. After Washing

Buzzer beep and "End" on display.

3 OPERATION

3.2 Before Each Washing

- The ambient temperature of the machine should be 5°C-40°C. If used under 0°C, the inlet valve and draining system may be damaged. If the machine is installed under freezing conditions, it should be transferred to normal ambient temperature to ensure the water supply hose and drain hose can unfreeze before use.
- Please check your laundry care labels and the detergent use instructions before wash. Use non-foaming or less-foaming detergent suitable for washing machine properly.

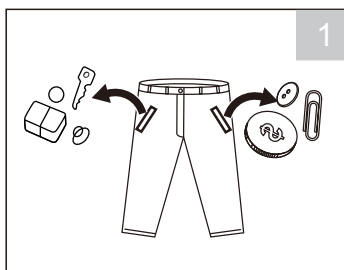

Take all items out of the pockets

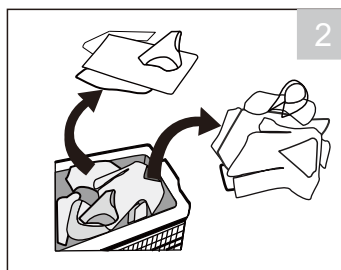

Sort laundry according to color and textile type

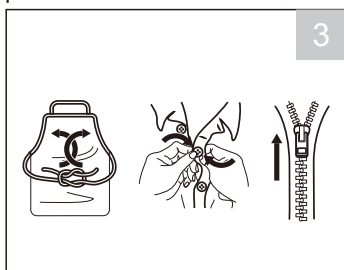

Tie together long textile strips and belts, close zips and button

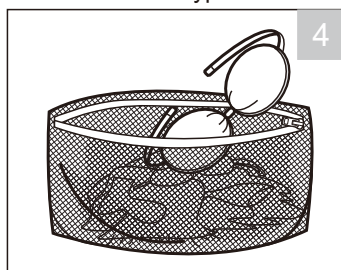

Put small items into a laundry bag

Warning!

- Do not wash articles that have been cleaned in, washed in, soaked in, or dabbed with combustible or explosive substances like wax, oil, paint, gasoline, alcohol, kerosene, and other flammable materials.
- Washing single clothes items may easily create big eccentricity . Therefore it is suggested to add one or two more laundry items to the wash so that spin can be done smoothly.
- Do not wash, spin, water-proof seats, mats, or clothing.

3 OPERATION

3.3 Detergent Dispenser

- I Pre wash
- II Main wash
- ☼ Softener
- ⊞ Release button to pull out the dispenser

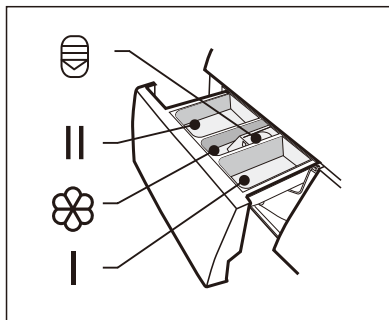

Caution!

- Detergent only need to be added in “compartment I” after selecting pre-wash function.
- Do not put laundry beads into the detergent dispenser.

Programme	I	II	☼	Programme	I	II	☼
Cotton 30 °C	○	●	○	Delicate 30 °C		●	○
Cotton 40 °C	○	●	○	Delicate		●	○
Cotton 60 °C	○	●	○	Ends in 9H		●	○
Cotton 90 °C	○	●	○	Ends in 6H		●	○
Synthetic	○	●	○	Ends in 3H		●	○
Synthetic 40 °C	○	●	○	Quick Wash 45'		●	○
Drum Clean				Quick Wash 30'		●	○
Cold Wash	○	●	○	Quick Wash 15'		●	○
Cold Wash 20 °C	○	●	○	ECO 40-60		●	○
Spin Only				Cotton Intensive 40 °C		●	○
Steam Wash	○	●	○	Cotton Intensive 60 °C		●	○
Rinse&Spin			○				

● Means must ○ Means optional

3 OPERATION

Detergent Recommendation

Recommended washing detergent	Wash cycles	Washing temp.	Type of laundry and textile
Heavy-duty detergent with bleaching agents and optical brighteners	Cotton, ECO 40-60	20/30/40/60	White laundry made from boil-proof cotton or linen
Colour detergent without bleaching agent and optical brighteners	Cotton, ECO40-60, Cold Wash	Cold/20/30/40	Coloured laundry made from cotton or linen
Color or mild detergent without optical brighteners	Cold Wash, Synthetic	Cold/20/40	Coloured laundry made from easy care fibres or synthetic materials
Mild washing detergent	Synthetic	Cold /40	Delicate textiles, silk, viscose



Note!

- Agglomerating or ropy detergent or additive can be diluted in some water before pouring it into the detergent dispenser, to avoid its inlet to get blocked and thus cause a water overflow.
- Please choose the suitable type of detergent to get a maximum of washing performance and a minimum of water and energy consumption.
- To achieve the best cleaning result a proper detergent dosing is important.
- Use a reduced detergent amount if the drum is not filled completely.
- Always adjust the amount of detergent to the water hardness, if your tap water is soft, use less detergent.
- Dose according to how dirty your laundry is, less dirty clothes require less detergent.
- Highly concentrated (compact detergent) requires particularly accurate dosing.

Following symptoms are a sign of detergent overdosing:

- heavy foam formation
- poor washing and rinsing result

Following symptoms are a sign of detergent underdosing:

- laundry turns grey
- built-up of limescale deposits on the drum, the heating element and/or the laundry

3 OPERATION

■ 3.4 Control Panel

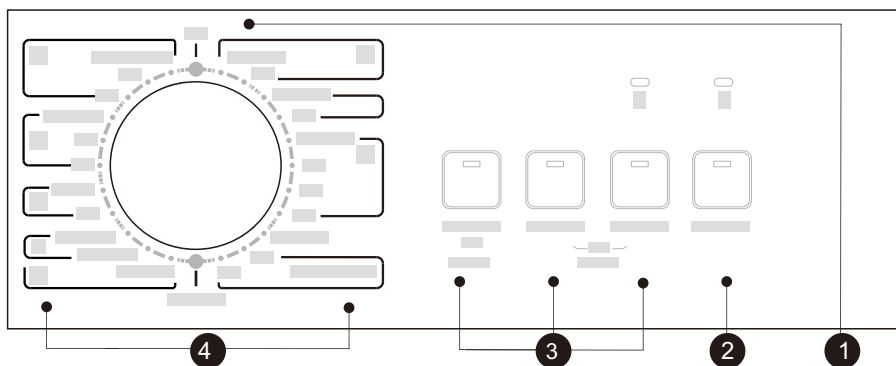

1 On/Off

Turn the appliance on and off.

2 Start/Pause

Start or pause your programme.

3 Option

This allows you to select additional functions and will light when selected.

4 Programmes

Available according to the laundry type.

3 OPERATION

■ 3.5 Programmes

Programmes are available according to the laundry type.

Programmes	
Synthetic	Wash synthetic articles, for example: shirts, coats, blending. While washing the knitting textiles, detergent quantity shall be reduced due to its loose string construction and easily forming bubbles.
Cold Wash	Cold water to wash clothes.
Cotton	Hard-wearing textiles, heat-resistant textiles made of cotton or linen.
ECO 40-60	Default 40°C, not selectable, suitable for laundry washing at about 40°C-60°C.
Cotton Intensive	To increase the washing effects, washing time is increased.
Drum Clean	It applies 90 °C high temperature sterilization to make the clothes washing more green. When this procedure is performed, the clothes or other washing cannot be added. When proper amount of chlorine bleaching agent is put in, the barrel cleaning effect will be better. The customer can use this programme regularly according to the need.
Steam wash	The Steam Wash can deeply penetrate the fiber, which effectively eliminates bacteria and germs, preventing odors and protecting health.
Spin Only	Extra spin with selectable spin speed.
Rinse & Spin	Extra rinse with spin.
Delicate	For delicate, washable textiles, e.g. made of silk, satin, synthetic fibres or blended fabrics.
Ends in	The function can be set with this programme, the total time including washing time and delaying time is 3h, 6h or 9h.
Quick Wash 15'	It is suitable for washing few and not very dirty clothes quickly.

3 OPERATION

Model:MFE60-U1002/C31-EU(ND)

Programme	Load(kg)	Display Time
	6.0	6.0
Synthetic	3.0	2:20
Synthetic 40℃	3.0	2:20
Cold Wash	6.0	1:00
Cold Wash 20℃	6.0	1:01
Cotton 30℃	6.0	2:40
Cotton 40℃	6.0	2:40
Cotton 60℃	6.0	2:45
Cotton 90℃	6.0	2:50
ECO 40-60	6.0	3:13
Cotton Intensive 40℃	6.0	3:48
Cotton Intensive 60℃	6.0	3:53
Drum Clean	-	1:18
Spin Only	6.0	0:12
Steam Wash	3.0	1:27
Rinse&Spin	6.0	0:20
Delicate 30℃	2.5	0:50
Delicate	2.5	0:48
Ends in 9H	6.0	0:59
Ends in 6H	6.0	0:59
Ends in 3H	6.0	0:59
Quick Wash 45'	2.0	0:45
Quick Wash 30'	2.0	0:30
Quick Wash 15'	2.0	0:15



Note!

- The parameters in this table are only for user's reference.
The actual parameters maybe different with the parameters in above mentioned table.

3 OPERATION

MFE60-U1002/C31-EU(ND)

Cycle	Nominal capacity in kg	Temperature setting	Cycle duration in h:min	Energy consumption in kWh/cycle	Water consumption in L/cycle	Highest washing temperature °C ¹⁾	Residual moisture in % / Spin speed ²⁾
Cold Wash 20°C	3.0	20	1:01	0.207	37	20	65%/1000
Cotton 60°C	6.0	60	2:45	1.280	58	60	70%/800
Synthetic	3.0	Cold	2:20	0.327	55	Cold	65%/1000
Quick Wash 15'	2.0	Cold	0:15	0.035	32	Cold	75%/800
Cotton Intensive 40°C	6.0	40	3:48	1.085	58	40	65%/1000
ECO 40-60 ³⁾	6.0	—	3:13	0.862	50.5	41	61%/1000
	3.0	—	2:36	0.540	38	34	61%/1000
	1.5	—	2:36	0.369	35	27	61%/1000

- The above data is for reference only, and the data may change due to different actual use conditions.
- The valves given for programmes other than the ECO 40-60 programme are indicative only.
- Concerning to EN 60456:2016+A11:2020 With(EU) 2019/2014, (EU) 2019/2023, (EU) 2021/340, (EU) 2021/341, The EU energy efficiency class is: D
Energy test program: ECO 40-60. Other as the default.
Half load for 6.0kg machine:3.0kg.
Quarter load for 6.0kg machine:1.5kg.

3 OPERATION

- 1) The highest temperature reached by the laundry in the wash cycle for at least 5 minutes.
- 2) Residual moisture after the wash cycle in water content percent and the spin speed at which this was achieved.
- 3) The ECO 40-60 programme is able to clean normally soiled cotton laundry declared to be washable at 40°C or 60°C, together in the same cycle. This programme is used to assess the compliance with the regulation (EU) 2019/2014, (EU) 2019/2023, (EU)2021/340, (EU) 2021/341.

The most efficient programmes in terms of energy consumption are generally those that perform at lower temperatures and longer duration.

Loading the household machine up to the capacity indicated for the respective programmes will contribute to energy and water savings.

Noise and remaining moisture content are influenced by the spinning speed: the higher the spinning speed in the spinning phase, the higher the noise and the lower the remaining moisture content.



Caution!

- If there is any break in the power supply while the machine is operating, a special memory stores the selected programme. The machine will continue the programme when the power supply is re-established.

3 OPERATION

3.6 Option

Cycle	Default Temp.(°C)	Default spin speed	Additional functions
Synthetic	Cold	1000	Pre Wash,Extra Rinse
Synthetic 40°C	40	1000	Pre Wash,Extra Rinse
Cold Wash	Cold	1000	Pre Wash,Extra Rinse
Cold Wash 20°C	20	1000	Pre Wash,Extra Rinse
Cotton 30°C	30	1000	Pre Wash,Extra Rinse
Cotton 40°C	40	1000	Pre Wash,Extra Rinse
Cotton 60°C	60	1000	Pre Wash,Extra Rinse
Cotton 90°C	90	1000	Pre Wash,Extra Rinse
ECO 40-60	30	1000	
Cotton Intensive 40°C	40	1000	
Cotton Intensive 60°C	60	1000	
Drum Clean	90	400	
Spin Only	-	1000	
Steam Wash	40	1000	Extra Rinse
Rinse & Spin	-	1000	Extra Rinse
Delicate 30°C	30	600	Extra Rinse
Delicate	Cold	600	Extra Rinse
Ends in 3H/6H/9H	40	1000	Delay
Quick Wash 45'	40	800	
Quick Wash 30'	30	800	
Quick Wash 15'	Cold	800	



Note!

- For the maximum spin speed, program time, and other details of the ECO 40-60 program, please refer to the content on the Product Fiche page.
- The table shows which cycle offers which options for adjustment.

3 OPERATION

Prewash: The Prewash function can get an extra wash before main wash, it is suitable for washing the dust rises to surface of the clothes; You need to put detergent into the Case (I) when select it.

Extra Rinse: The laundry will undergo extra rinse once after you select it.

No Spin: It will not spin if you choose this function.



Mute the buzzer



Choose the Programme

Press the [Prewash] button for 3 sec. the buzzer is mute.

To act the buzzer function, press the button again for 3 seconds. The setting will be kept until the next reset.



Caution!

- After Muting the buzzer function, the sounds will not be activated any more.



Child Lock

To avoid mis operation by children.



Choose the
Programme

Start

Press [Extra Rinse] and [No Spin]
3 sec. till buzzer beep.



Caution!

- Only press and hold the two button can release “Child Lock”, even power off, switch off and program end, the “Child Lock” will lock all buttons except power button and “Child Lock” button.
- Please release “Child Lock” before selecting program and starting washing.

4 MAINTENANCE

■ 4.1 Cleaning and Care



Warning!

- Always unplug the appliance and close the water tap before cleaning and maintenance.

Cleaning the Cabinet

Proper maintenance on the washing machine can extend its working life. The surface can be cleaned with diluted non-abrasive neutral detergents when necessary. If there is any water overflow, use a towel to wipe it off immediately. Never use sharp items to clean the appliance.

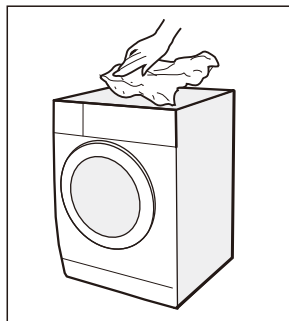

Caution!

- Never use abrasive or caustic agents, formic acids or its diluted solvents or similar substances, like alcohol or chemical products.

Cleaning the Drum

Any rust stains left inside the drum by metal articles must be removed immediately using chlorine-free detergents. Never use steel wool for cleaning the drum!



Note!

- Keep any laundry away from the machine while cleaning the drum.

Cleaning the Door Seal and Glass

Wipe the glass and seal after each wash to remove lint and stains. If lint builds up it can cause leakages.

Remove any coins, buttons and other objects from the seal after each wash.

Clean the Door Seal and Glass every month to ensure the normal operation of the appliance.

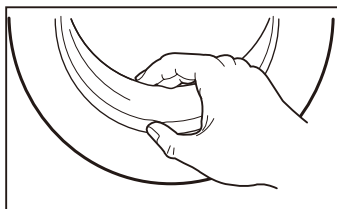

4 MAINTENANCE

Cleaning the Inlet Filter



Note!

- Diminishing water flow is a sign that the filter need to be cleaned.

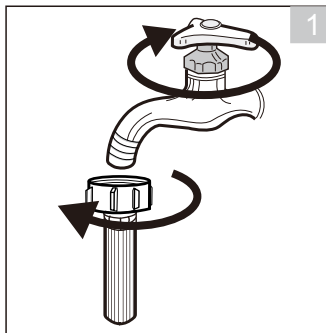

1. Close the tap and remove the water supply hose from it.

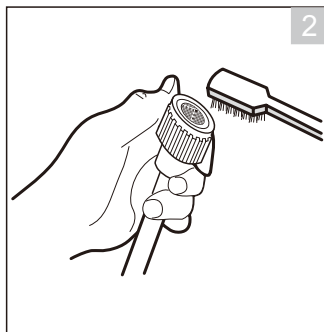

2. Clean the filter with a brush.

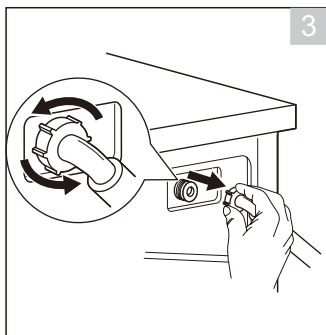

3. Unscrew the water supply hose from the backside of the machine. Pull out the filter with long nose pliers.

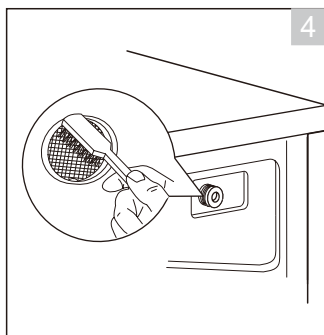

4. Use a brush to clean the filter.

5. Reinstall the filter to the water inlet and reconnect the water supply hose.
6. Clean the Inlet filter every 3 months to ensure the normal operation of the appliance.

4 MAINTENANCE

Cleaning the Detergent Dispenser

1. Press down the release [] on the softener cover and pull the dispenser drawer out of the recess. Clean the inside of the recess with a brush.
2. Lift the softener cover off the dispenser drawer and wash both items with water.
3. Restore the softener cover and push the drawer back into the recess.

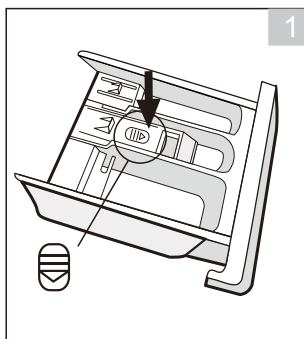

Press the release and remove the dispenser drawer

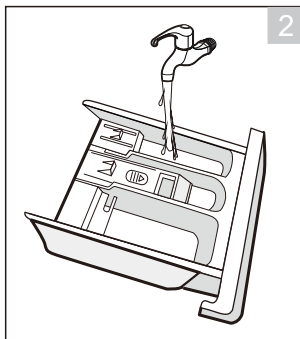

Clean the dispenser drawer and the softener cover under water

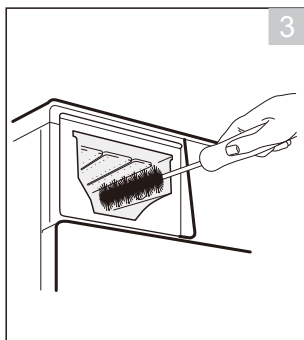

Clean the recess with an soft brush

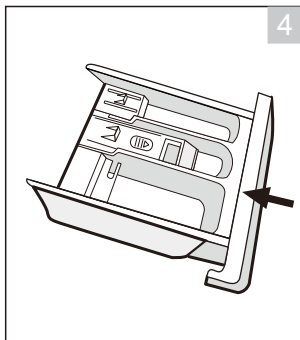

Insert the dispenser drawer



Note!

- Do not use abrasive or caustic agents to clean plastic parts.
- Clean the detergent dispenser every 3 months to ensure the normal operation of the appliance

4 MAINTENANCE

Cleaning the Drain Pump Filter

⚠ Warning!

- Make sure that the machine has finished the washing cycle and is empty. Switch it off and unplug it before cleaning the drain pump filter.
- Be careful of hot water. Wait for water cooling down. Risk of scalding!
- Clean the filter periodically every 3 months to ensure the normal operation of the appliance.

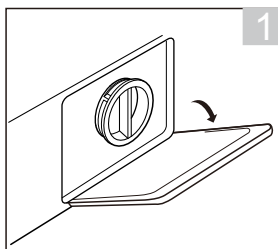

Open the lower cover cap

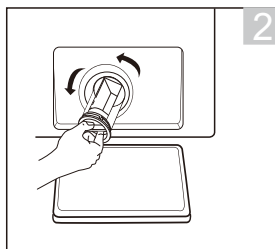

Open the filter by turning to the counter clockwise

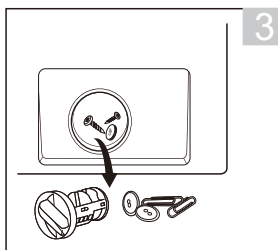

Remove extraneous matter

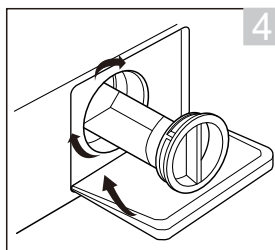

Close the lower cover cap

⚠ Caution!

- When the appliance is in use and depending on the programme selected there can be hot water in the pump. Never remove the pump cover during a wash cycle, always wait until the appliance has finished the cycle, and is empty. When replacing the cover, ensure it is securely re-tightened.

4 MAINTENANCE

4.2 Trouble Shooting

Whenever there is a problem with the appliance, check if you can solve it following the tables below. If the problem persists, please contact the customer service.

Description	Possible cause	Solution
Appliance does not start	Door is not closed properly. Clothes are stuck.	Close the door properly and restart. Check the laundry.
Door can't be opened	Safety protection is activated.	Disconnect the power and restart.
Water leakage	Connections are not tight enough.	Check and fasten the water inlet pipe. Check and clean the outlet hose.
Detergent residues in the detergent dispenser	Detergent is damp and/or clotted.	Clean and wipe the detergent dispenser dry.
Indicator or display does not work	PC board or harness have connection problems.	Switch off the power and check if the mains plug is connected properly.
Abnormal noise	Fixing bolts still in place. Floor is not solid or level.	Check if the fixing bolts have been removed. Make sure the appliance is installed on a solid and level floor.

Error Codes

Description					Reason	Solution
Prewash	Extra Rinse	No Spin	Pause/Start	End		
Off	Off	Off	Flash	Off	Door is not closed properly	Restart after the door is closed. Check if the clothes is stuck
Off	Off	Off	Flash	Off	Water injecting problem while washing	Check if the water pressure is too low Straighten the water pipe Check if the inlet valve filter is blocked
Off	Off	Flash	Flash	Off	Overtime water draining	Check if the drain hose is blocked
Off	Off	Off	Flash	Off	Water overflow	Restart the washer
					Others	Please try again first, call up service line if there are still troubles

4 MAINTENANCE

■ 4.3 Customer service

Spare part for your appliance are available for a minimum of 10 years following EU COMMISSION REGULATION 2019/2023 ANNEX II Ecodesign requirements..

In case of questions, please contact our local customer service center.



Warning!

Risk of electric shock

- Never try repair an appliance which is defective or presumed to be defective. You may put your own and future users' lives in danger. Only authorised specialists are allowed to carry out this repair work.
- Improper repair will void the warranty and subsequent damages can't be recognized!

Transport

IMPORTANT STEPS WHEN MOVING THE APPLIANCE

- Unplug the appliance and close the water inlet tap.
- Check, if the door and the detergent dispenser are closed properly.
- Remove the water inlet pipe and the outlet hose from the house installations.
- Let the water drain completely from the appliance (see "Maintenance Cleaning the drain pump filter")
- Important: Re-install the 4 transport bolts in the back of the appliance.
- This appliance is heavy. Transport with care. Never hold any protruding part of the machine when lifting. The machine door can not be used as a handle.

5 TECHNICAL SPECIFICATION

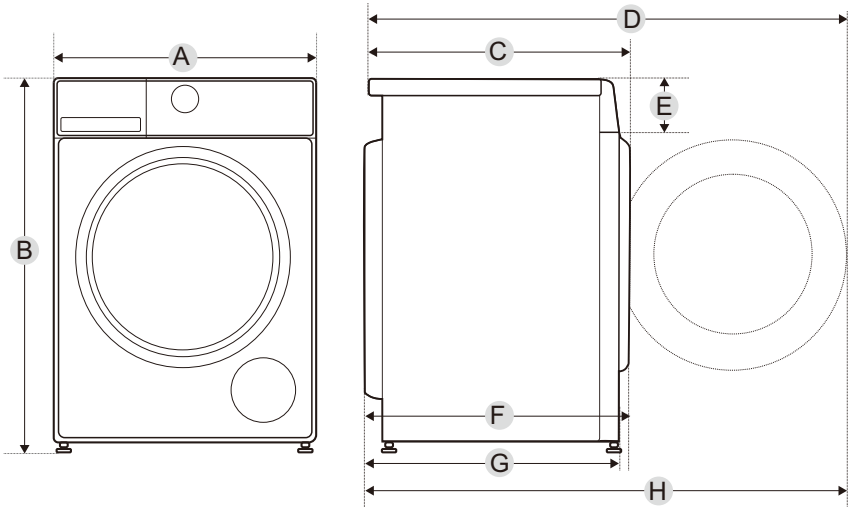

Model	MFE60-U1002/C31-EU(ND)
Power Supply	220-240V~,50Hz
MAX.Current	10A
Standard Water Pressure	0.05MPa~1MPa
Washing Capacity	6.0kg
Dimension	
A	595mm
B	850mm
C	435mm
D	890mm
E	156mm
F	440mm
G	400mm
H	900mm
Weight	55kg
Rated Power	2000W

6 PRODUCT FICHE

Supplier's name or trade mark^(*)(^(*)):

Supplier's address^(*)(^(*)):

Model identifier(_a):MFE60-U1002/C31-EU(ND)

General product parameters:

Parameter	Value		Parameter	Value	
Rated capacity ^(b) (kg)	6.0		Dimensions in cm ^(b) , (^(c))	Height	85
				Width	60
				Depth	40
Energy efficiency index ^(b) (EEI _w)	79.5		Energy efficiency class ^(b)	D ^(d)	
Washing efficiency index ^(b)	1.031		Rinsing effectiveness (g/kg) ^(b)	5.0	
Energy consumption in kWh per cycle, based on the eco 40-60 programme. Actual energy consumption will depend on how the appliance is used.	0.664		Water consumption in litre per cycle, based on the eco 40-60 programme. Actual water consumption will depend on how the appliance is used and on the hardness of the water.	43	
Maximum temperature inside the treated textile ^(b) (°C)	Rated capacity	41	Weighted remaining moisture content ^(b) (%)	62.9	
	Half	34			
	Quarter	27			
Spin speed ^(b) (rpm)	Rated capacity	1000	Spin-drying efficiency class ^(b)	C ^(d)	
	Half	1000			
	Quarter	1000			
Programme duration ^(b) (h:min)	Rated capacity	3:18	Type	free-standing	
	Half	2:36			
	Quarter	2:36			
Airborne acoustical noise emissions in the spinning phase ^(b) (dB(A) re 1 pW)	79		Airborne acoustical noise emission class ^(b) (spinning phase)	C ^(d)	
Off-mode (W) (if applicable)	0.50		Standby mode (W) (if applicable)	1.00	
Delay start (W) (if applicable)	4.00		Networked standby (W) (if applicable)	N/A	

Minimum duration of the guarantee offered by the supplier ^(*)(^(*)):

This product has been designed to release silver ions during the washing cycle

NO

Additional information:

Weblink to the supplier's website, where the information in point 9 of Annex II to Commission Regulation (EU) 2019/2023 (1) is found:

^(*) this item shall not be considered relevant for the purposes of Article 2(6) of Regulation (EU) 2017/1369.

^(b) for the eco 40-60 programme.

^(c) changes to this item shall not be considered relevant for the purposes of paragraph 4 of Article 4 of Regulation (EU) 2017/1369.

^(d) if the product database automatically generates the definitive content of this cell, the supplier shall not enter these data.

6 PRODUCT FICHE

- 1) The actual energy consumption will depend on how the appliance is used.
- 2) The actual water consumption will depend on how the appliance is used and on the hardness of the water.
- 3) Delivery of the spare parts within 15 working days after having received the order.

Product Data Sheet concerning (EU) 2019/2014, (EU) 2019/2023, (EU)2021/340, (EU) 2021/341.

The product data sheet for your appliance can be found online.
Go to <https://eprel.ec.europa.eu> and enter the model identifier for your appliance to download the data sheet.
The model identifier for your appliance can be found in the technical specifications section.

NOTES

Warranty

We provide a guarantee for this machine in accordance with the following conditions: You have a manufacturer's warranty of years from the date of purchase (proof of purchase must be provided). Our General Terms and Conditions apply.

Your device / serial number

Purchase date:

Place of purchase:

Do you have any questions ?

We are happy to support you !

<http://www.midea.com>



make yourself at home

V1.0

16138100009142

MFE60-U1002_C31-EU_ND-PM01